

# LTCC 带通滤波器 (LTCC Bandpass Filter) HT-B3216-27.5-31G+

50 Ω 27.5GHz to 31GHz

## Features

- Extremely wide passband, 27.5-31GHz
- Small size 1206(3.2x 1.6 mm )
- Temperature stable
- LTCC construction

## Applications

- Wireless communication
- Harmonic Rejection
- Transmitters / receivers

## Pad Connections

Input	1
Output	2
Ground	3

## Outline Drawing

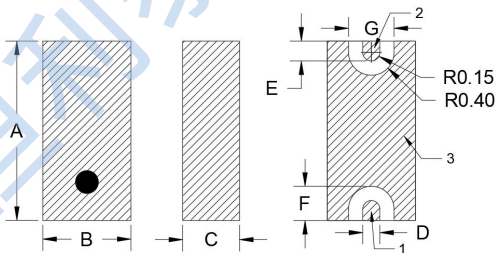

## Outline Dimensions : mm

A	B	C	D	E	F	G	Tol.
3.2	1.6	1.0	0.3	0.35	0.6	0.8	.020

## Suggested PCB Layout

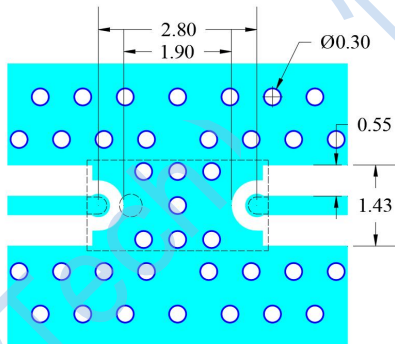

Note:

1. The trace width and spacing are as shown in the figure, using RO4350B dielectric with a thickness of 0.168 mm. The copper thickness on both sides is 1 OZ. If other materials are used, the trace width and spacing may need to be adjusted.
2. Continuous copper pour is applied on the back layer.

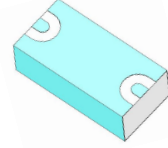
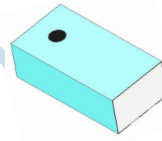

## Electrical Specifications(1) at 25°C

Parameter	Frequency (MHz)	Min.	Typ.	Max.	Unit	
Pass Band	Insertion Loss	27.5-31	—	1.5	2.8	dB
	VSWR	27.5-31	—	1.5	2.0	: 1
Stop Band	Rejection Loss	15-17.7	35	40	—	dB
		17.7-21.2	30	35	—	
		35-40	20	30	—	

## Typical Performance Data at 25°C

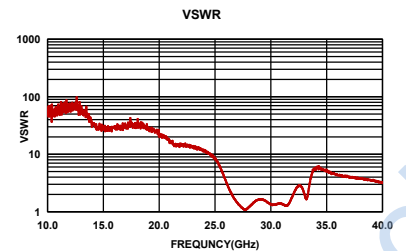
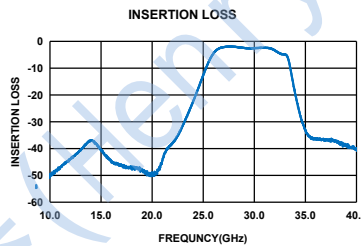

## Maximum Ratings

Operating Temperature	-55°C to +125°C
Storage Temperature	-55°C to +125°C
RF Power Input*	5W at 25°C

- \*1. Permanent damage may occur if any of these limits are exceeded.
2. Power rating applies only to signals within the passband.