

# LTCC 带通滤波器 (LTCC Bandpass Filter) HT-B3216-17.7-21.2G+

50 Ω 17.7GHz to 21.2GHz

## Features

- Extremely wide passband, 17.7-21.2GHz
- Small size 1206(3.2x 1.6 mm )
- Temperature stable
- LTCC construction

## Applications

- Wireless communication
- Harmonic Rejection
- Transmitters / receivers

## Pad Connections

Input	1
Output	2
Ground	3

## Outline Drawing

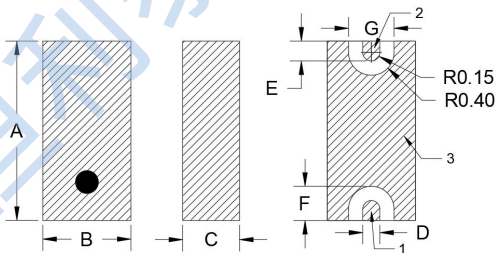

## Outline Dimensions : mm

A	B	C	D	E	F	G	Tol.
3.2	1.6	1.0	0.3	0.35	0.6	0.8	0.2

## Suggested PCB Layout

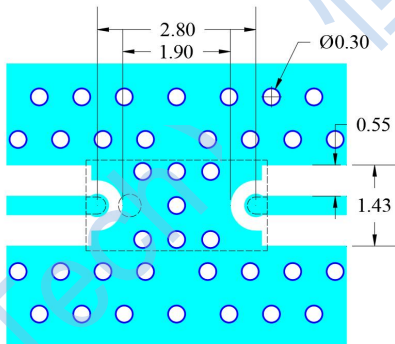

Note:

1. The trace width and spacing are as shown in the figure, using RO4350B dielectric with a thickness of 0.168mm. The copper thickness on both sides is 1 OZ. If other materials are used, the trace width and spacing may need to be adjusted.
2. Backside continuous ground plane.

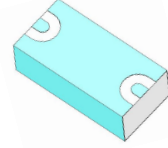
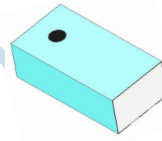

## Electrical Specifications(1) at 25°C

Parameter	Frequency (MHz)	Min.	Typ.	Max.	Unit	
Pass Band	Insertion Loss	17.7-21.2	—	1.5	2.0	dB
	VSWR	17.7-21.2	—	1.5	2.0	: 1
Stop Band	Rejection Loss	8-15	20	30	—	
		27.5-31	30	35	—	dB
		31-40	30	35	—	

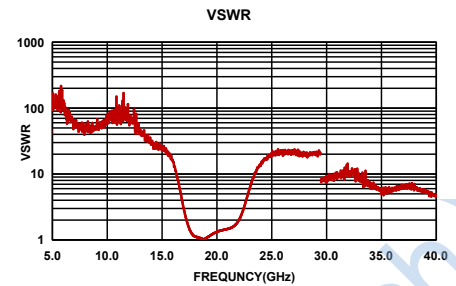
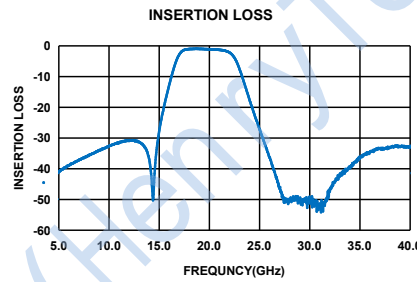

## Maximum Ratings

Operating Temperature	-55°C to +125°C
Storage Temperature	-55°C to +125°C
RF Power Input*	5W at 25°C

- \*1. Permanent damage may occur if any of these limits are exceeded.
2. Power rating applies only to signals within the passband.