

H3-B50-4-1600-3500M

1600-3500MHz 50Ω 1:4 Ratio Balun

APPLICATIONS

- Ideally suitable for PCS, wideband push-pull amplifiers and cellular applications.

FEATURES

- Surface mount
- Impedance ratio: 1:4
- Available on tape and reel
- RoHS compliant and Pb free
- 260°C reflow compatible

DIMENSIONS

Land Pattern

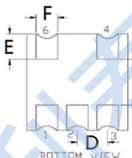
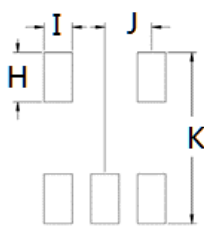
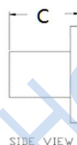
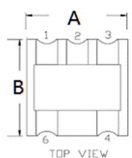

A	B	C	D	H	I	J
4.21	4.21	3.00	1.27	1.40	0.76	1.27
E	F	G		K		
1.11	0.90	2.00		4.83		

Unless otherwise stated dimensions are in mm

Tolerance: .xx ± 0.25, .xxx ± 0.05

ELECTRICAL SPECIFICATIONS@25°C:

Parameters (P#: ENA PORT)	frequency band	Min.	Typ.	Max.	Unit
Port Impedance, Z0 (P1)			50		Ohm
Insertion Loss	1600-3500MHz		1.6	3.0	dB
Phase Balance	1600-3500MHz		12.0		Deg
Amplitude Balance	1600-3500MHz		1.5		dB

TEST CURVE

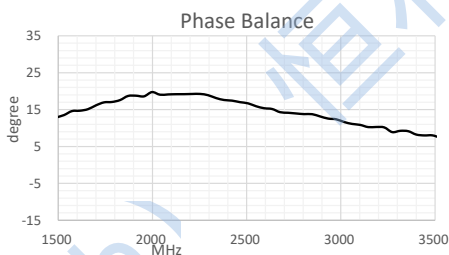
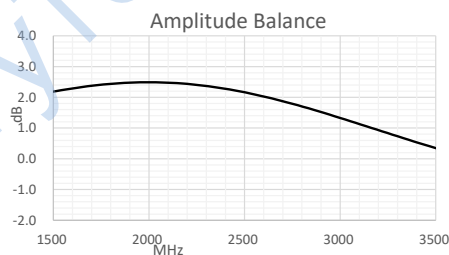
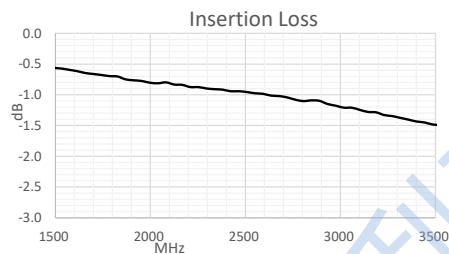
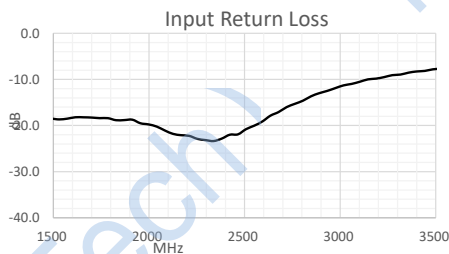

FUNCTIONAL SCHEMATIC

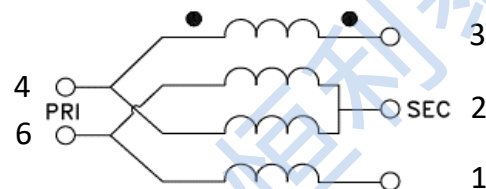

Turns Ratio: 3:3:3:3

Pin Configuration

Pin No.	Function
1	Secondary
2	Secondary CT(Ground)
3	Secondary Dot
4	Primary(Ground)
6	Primary Dot

APPLICATION & TEST CIRCUIT

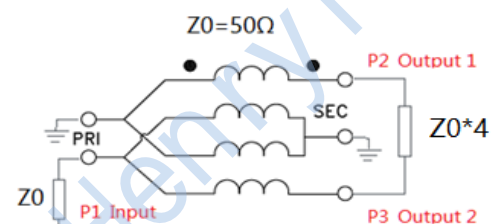

ABSOLUTE MAXIMUM RATINGS

Parameter	Value
RF Power	0.4W
DC Current	30mA
Operating Temperature Range	-40 to 85°C
Storage Temperature Range	-55 to 100°C

Tel: +86-28-85589664

E-mail: mr_li@henglitaitech.com

Web: www.hltchips.com

Adress:Room 1401, 14th Floor, Building 5, Huaxi Science and Technology Innovation Center, No. 50, Shuxi Road, Jinniu District, Chengdu City